

## Key Features

- ⊙ **Strength**  
(Made from Galvanised Steel)
- ⊙ **Visibility**  
(Yellow finish is highly visible)
- ⊙ **Corrosion Resistant**  
(Galvanised for corrosion and weather resistance)
- ⊙ **Secure**  
(Bolt down installation)

## Suitable For

- ⊙ **Public areas**
- ⊙ **Warehouses**
- ⊙ **Car parks**
- ⊙ **Industrial sites**

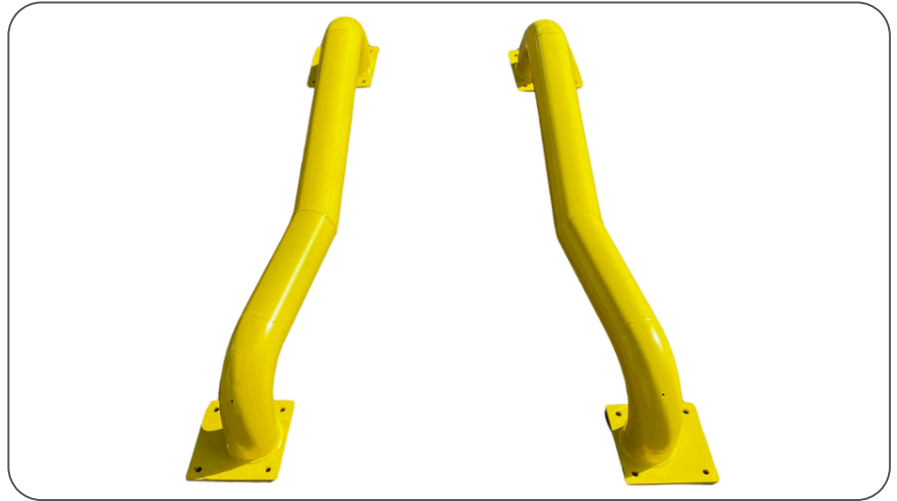

### Versatile

Ideal for indoor or outdoor use, in high-traffic and pedestrian areas.



### Corrosion Resistant

These Wheel Guides are made from Galvanised Steel to secure against corrosion.

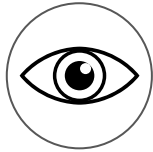

### High Visibility

Bold Yellow finish is designed to be highly visible, perfect for industrial sites with heavy machinery.

## Specifications

Diameter	139mm, 168mm
Length	1800mm
Material	Galvanised Steel
Finish	Galvanised, Yellow



 Call our Expert Sales Team for more information

First Fence Ltd | Kiln Way, Woodville, South Derbyshire, DE11 8EA  
01283 512 111 | [www.firstfence.co.uk](http://www.firstfence.co.uk) | [sales@firstfence.co.uk](mailto:sales@firstfence.co.uk)

Bristol | Canvey | Glasgow | Nottingham | Tipton