

80x80x3 / 100x100x3 /  
120x120x4 / 150x150x5 /  
200x200x5 BOX SECTION HINGE POSTS

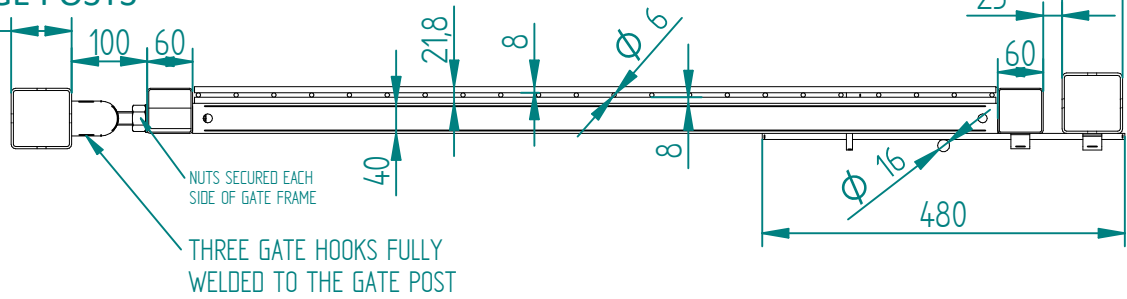

80x80x3 / 100x100x3  
BOX SECTION CATCH POSTS

SECURITY PADLOCK CAN BE LOCKED VIA  
TWO POSITIONS ON THE SLIDER ASSEMBLY

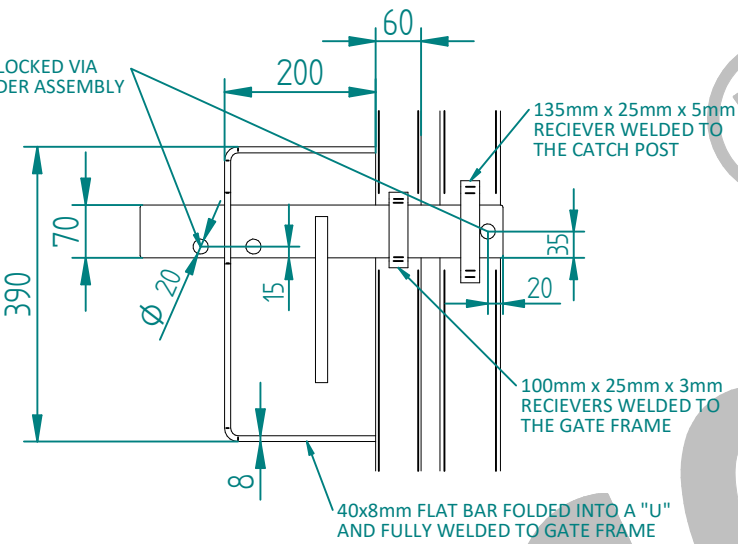

GENERIC SLIDER CONFIGURATION  
& LOCKING ARRANGEMENT

NOTES:

- ALL MATERIALS TO BE MILD STEEL AND CONFORM TO RELEVANT BRITISH STANDARDS.
- ALL ITEMS TO BE PRE-GALVANISED TO BS EN 10346 OR HOT DIP GALVANISED TO ISO 1461
- ITEMS CAN BE POWDER COATED ON REQUEST, POWDER COATING TO : BS EN 13438
- INSTALLATION VIA RAMS

ALL GATES & POSTS ARE TO BE  
FITTED WITH BLACK PLASTIC INSERTS

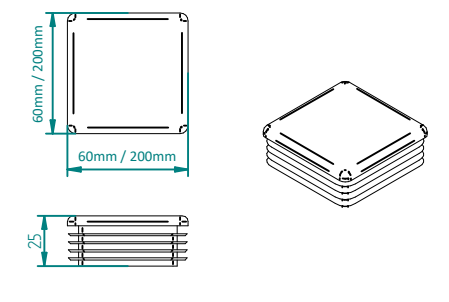

ALL GATES WITH 80x80/100x100/120x120  
BOX SECTION HINGE POSTS ARE TO BE FITTED  
WITH GALVANISED EYE BOLTS & M8x40mm  
SADDLE BOLT / SHEAR NUT

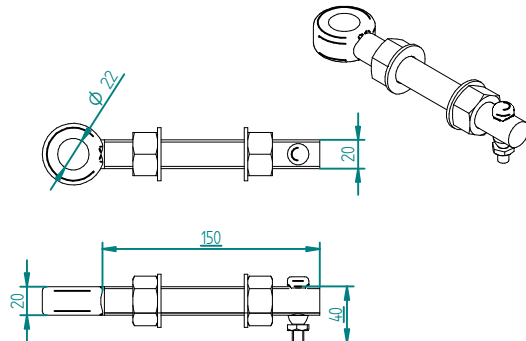

ALL GATES WITH 150x150 / 200x200 BOX SECTION  
HINGE POSTS ARE TO BE FITTED WITH GALVANISED  
EYE BOLTS & M8x40mm SADDLE BOLT / SHEAR NUT

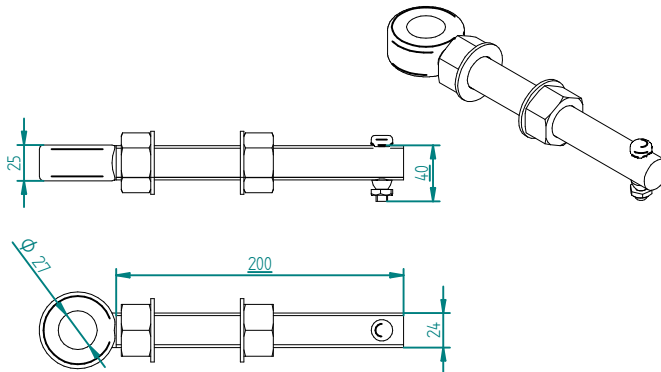

FOR GATES TO BE COMPLIANT THEY MUST  
BE FITTED WITH ONE OF THE PADLOCKS BELOW

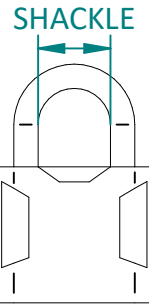

Henry Squire & Son PadLocks List

Product Name	Shackle (mm)	Security Rating
SS50S	26.0	2
SS50CS	16.0	2
SS65S	29.0	3
SS65CS	19.0	3
SS80S	34.5	3

NAME	DATE	TITLE
DRAWN	LT	16/08/23
TOLERANCE	± 2mm Unless Stated Otherwise	
3RD ANGLE		
NOTE: SHOULD ANY DISCREPANCIES BE FOUND WITH THIS DRAWING, PLEASE INFORM FIRSTFENCE. COPYRIGHT OF THIS DRAWING IS OWNED BY FIRSTFENCE LIMITED.		
SIZE A2		REV A
WEIGHT: N/A		SHEET 1 OF 2

POST CENTRES ( 1390, 2200, 3210, 4235, 5260 )

(1.185m WIDE) 1.985 - 4.985m WIDE EACH GATE INCREASES BY 1.0m

A vertical support of equal specification to the gate frame should be welded vertically between top and bottom cross member to ensure no mesh panel exceeds 2500mm wide, vertical supports can be added on all gates at min of 0.8m centres to create a more rigid frame.

All gate post are to have 12Φ thru holes to allow fixing of mesh fencing panel. All hole positions are to match the fencing system

DROP BOLTS ARE USED TO HOLD THE GATE IN THE OPEN POSITION

DROP BOLTS ARE TO BE FITTED WITH A M5x20 ONEWAY PAN HEAD BOLT & M5 SHEAR NUT VIA 8Φ HOLE TO PREVENT REMOVAL OF THE DROP BOLT

TWO 26.9Φ x 40mm GUIDES WELDED TO GATE FRAME

ALL GATES ABOVE 1200mm  
WIDE REQUIRE DROP BOLTS

DIG IN SINGLE LEAF GATE INTERNAL VIEW  
OPENING 90° IN / OUT

50mm GROUND CLEARANCE

FOR 80x80/100x100 BOX SECTION POST (LENGTH = GATE HEIGHT + 700mm)  
FOR 120x120/150x150/200x200 BOX SECTION POST (LENGTH = GATE HEIGHT + 1000mm)

750x 300 x 300 CONCRETE FOUNDATION  
GRADE: C20/25.  
THESE ARE MINIMUM FOUNDATIONS REQUIRED  
AND MAY INCREASE WITH HIGHT OF GATE

80x80x3 / 100x100x3 /  
120x120x4 / 150x150x5 /  
200x200x5 BOX SECTION HINGE POSTS

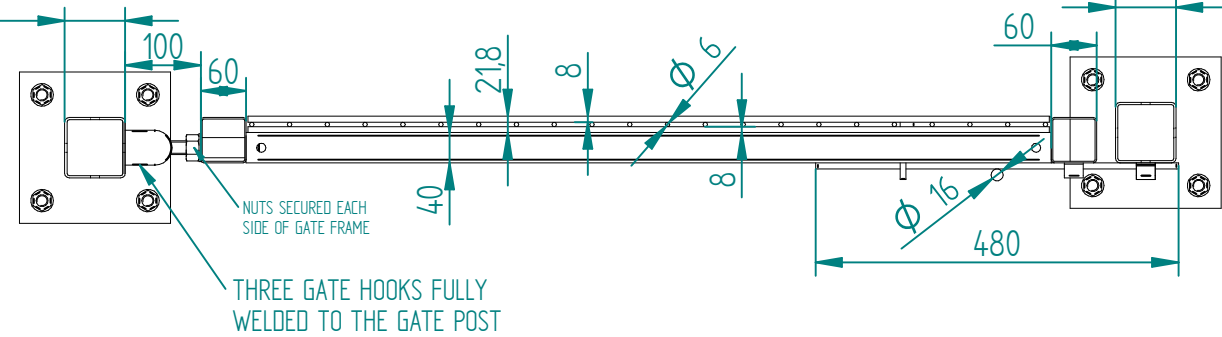

SECURITY PADLOCK CAN BE LOCKED VIA TWO POSITIONS ON THE SLIDER ASSEMBLY

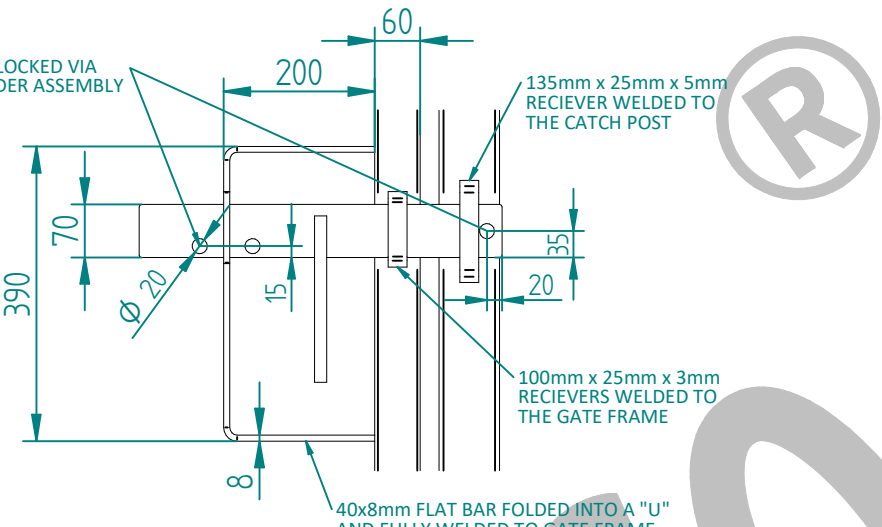

GENERIC SLIDER CONFIGURATION & LOCKING ARRANGEMENT

NOTES:

- ALL MATERIELS TO BE MILD STEEL AND CONFORM TO RELEVANT BRITISH STANDARDS.
- ALL ITEMS TO BE PRE-GALVANISED TO BS EN 10346 OR HOT DIP GALVANISED TO ISO 1461
- ITEMS CAN BE POWDER COATED ON REQUEST, POWDER COATING TO : BS EN 13438
- INSTALLATION VIA RAMS
- BOLT DOWN FIXING : REV THROUGH BOLTS ETA\_AWA\_RE02

ALL GATES & POSTS ARE TO BE FITTED WITH BLACK PLASTIC INSERTS

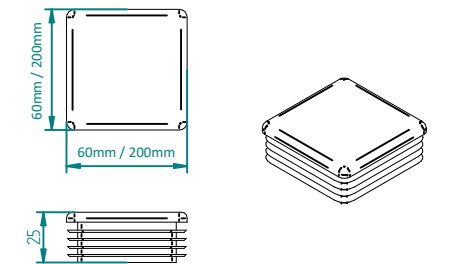

ALL GATES WITH 80x80/100x100/120x120 BOX SECTION HINGE POSTS ARE TO BE FITTED WITH GALVANISED EYE BOLTS & M8x40mm SADDLE BOLT / SHEAR NUT

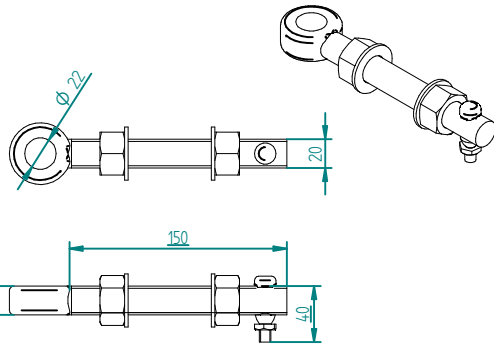

ALL GATES WITH 150x150 / 200x200 BOX SECTION HINGE POSTS ARE TO BE FITTED WITH GALVANISED EYE BOLTS & M8x40mm SADDLE BOLT / SHEAR NUT

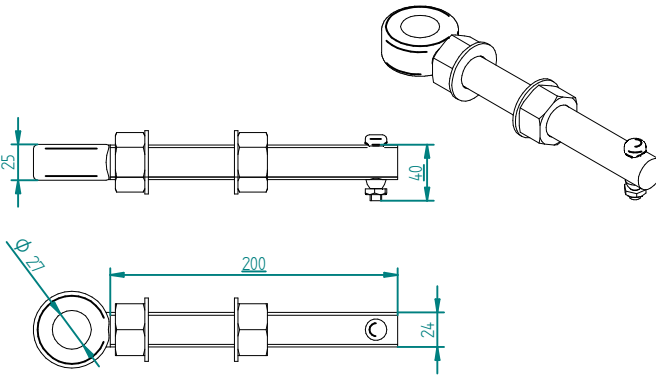

FOR GATES TO BE COMPLIANT THEY MUST BE FITTED WITH ONE OF THE PADLOCKS BELOW

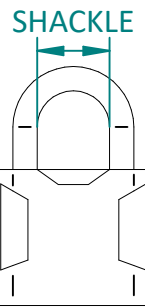

Henry Squire & Son Padlocks List

Product Name	Shackle (mm)	Security Rating
SS50S	26.0	2
SS50CS	16.0	2
SS65S	29.0	3
SS65CS	19.0	3
SS80S	34.5	3

1800 / 2000 / 2400 / 3000  
OVERALL HEIGHT FROM TOP OF GATE POST TO FINISH GROUND LEVEL

1510 / 1910 / 2410 VARIES WITH EACH HEIGHT OF GATE FRAME

835 / 1035 / 1435 VARIES WITH EACH HEIGHT OF GATE FRAME

POST CENTRES ( 1390, 2200, 3210, 4235, 5260 )

(1.185m WIDE) 1.985 - 4.985m WIDE EACH GATE INCREASES BY 1.0m

868 MESH SHEET IS TO BE WELDED WITHIN THE GATE FRAME, (4mm FILLET x 40mm LONG / MUST NOT EXCEED 500mm CENTRES ACROSS THE TOP AND BOTTOM ONLY) (EVERY 8mm HORIZONTAL WIRE MUST BE FULLY WELDED TO BOTH SIDES OF THE GATE FRAME)

A vertical support of equal specification to the gate frame should be welded vertically between top and bottom cross member to ensure no mesh panel exceeds 2500mm wide, vertical supports can be added on all gates at min of 0.8m centres to create a more rigid frame.

All gate post are to have 12Φ thru holes to allow fixing of mesh fencing panel. All hole positions are to match the fencing system

DROB BOLTS ARE USED TO HOLD THE GATE IN THE OPEN POSITION

DROP BOLTS ARE TO BE FITTED WITH A M5x20 ONEWAY PAN HEAD BOLT & M5 SHEAR NUT VIA 80° HOLE TO PREVENT REMOVAL OF THE DROP BOLT

TWO 26.9Φ x 40mm GUIDES WELDED TO GATE FRAME

ALL GATES ABOVE 1200mm WIDE REQUIRE DROP BOLTS

C20/25 MINIMUM CONCRETE FOUNDATION GRADE

BOLT DOWN SINGLE LEAF GATE INTERNAL VIEW OPENING 90° IN / OUT

50mm GROUND CLEARANCE

Min OF 4 NO. M16x125mm ANCHOR BOLTS FITTED IN ACCORDANCE WITH MANUFACTURERS INSTRUCTIONS.

SHS fully welded to base plate

NAME	DATE	TITLE
DRAWN LT	16/08/23	ProFence 1.8m - 3.0m High x 1.2m - 5.0m Wide Single Leaf 868 Mesh Gate Details
TOLERANCE	± 2mm Unless Stated Otherwise	
3RD ANGLE		
NOTE: SHOULD ANY DISCREPANCIES BE FOUND WITH THIS DRAWING, PLEASE INFORM FIRSTFENCE. COPYRIGHT OF THIS DRAWING IS OWNED BY FIRSTFENCE LIMITED.		
SIZE A2		REV A
WEIGHT: N/A		SHEET 2 OF 2