

July 2025

# Press Release

## FFL Swing Gates Range - in Partnership with Wisniewski

*First Fence Launches Wisniewski Swing Gates To The UK Market, With Manual and Automatic Options Available.*



01283 512 111



[www.firstfence.co.uk](http://www.firstfence.co.uk)



[sales@firstfence.co.uk](mailto:sales@firstfence.co.uk)

# The FFL Range Has Expanded

First Fence is proud to announce a significant expansion of its swing gate offerings, in collaboration with Wisniewski, a renowned European manufacturer of gates, fences and doors.

Introducing a comprehensive range that encompasses manual, automation-ready, and solutions with full automation bundles. This strategic enhancement underscores the company's unwavering commitment to delivering high-quality, durable, and tailored security solutions for diverse applications, from residential properties to demanding commercial and industrial environments. The new range represents a proactive response to evolving customer needs, providing versatile and reliable access control options designed for both immediate functionality and future scalability.

## Gate Types Available

	Primary Use	Key Advantage
Manual Swing Gates	Basic Access Control	Robust & Reliable
Automation-Ready Swing Gates	Future-Proofed Security	Adaptable & Scalable
Fully Automated Swing Gate Kits	Ultimate Convenience & Security	Smart & Effortless



*Example FFL60D - Manual 868 Mesh Infill Double Leaf Swing Gate*



## Variations Available

<b>FFL 60S</b>	<b>Single Leaf Gate up to 3m Opening</b> <b>60x60 box section frame</b>
<b>FFL 60D</b>	<b>Double Leaf Gate up to 6m Opening</b> <b>60x60 box section frame</b>
<b>FFL 80S</b>	<b>Single Leaf Gate up to 5m Opening</b> <b>80x80 box section frame</b>
<b>FFL 80D</b>	<b>Double Leaf Gate up to 10m Opening</b> <b>80x80 box section frame</b>

**Infill Types: Vertical Bar | 868 Mesh**



Other infill options are available on request, Palisade, 358 Mesh, V Mesh and several more.



01283 512 111



[www.firstfence.co.uk](http://www.firstfence.co.uk)



[sales@firstfence.co.uk](mailto:sales@firstfence.co.uk)

## 3 Purchasing Options: Giving You The Choice

### Manual Gates:

All gates come with 1 or 2 gate leaves, 2 x 160mm bolt down posts with 220mm ground anchors and 1 Locinox U-Safe gate safety tether per leaf.

All manual gates come with Locinox swing gate locks.

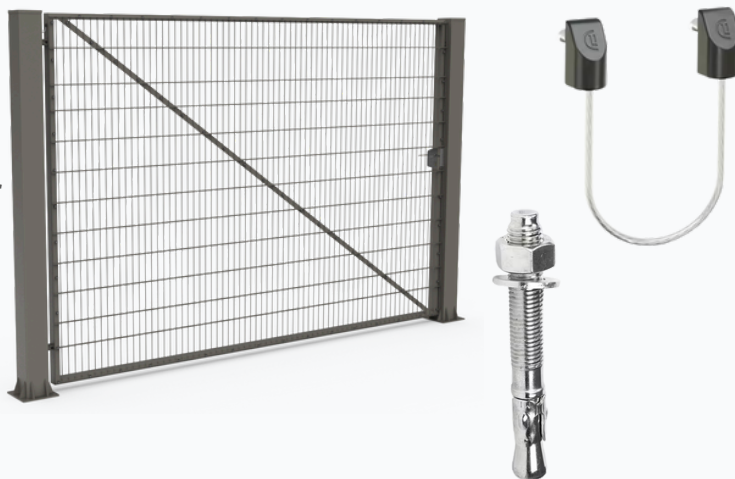

### Prepped For Automation:

All gates come with 1 or 2 gate leaves, 2 x 160mm bolt down posts with 220mm ground anchors and 1 automation mounting section on the back of each leaf.

No automation or safety is included in this option.



### With Automation Bundle:

All gates come with 1 or 2 gate leaves, 2 x 160mm bolt down posts with 220mm ground anchors, 1 Locinox U-Safe per leaf.

Specially selected automation bundles include a full Beninca above ground automation kit plus a host of extras shown here.

# A full on site risk assessment is required when automating any gates as additional safety devices may be required #

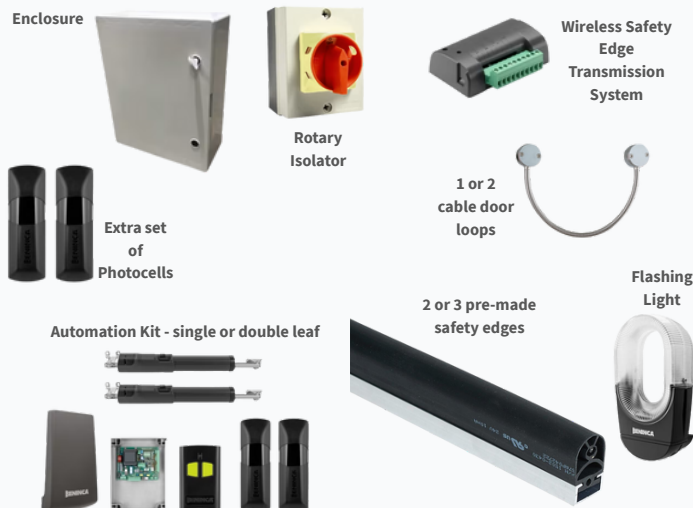

## Size Range and Colours Available

### Sizes Available:

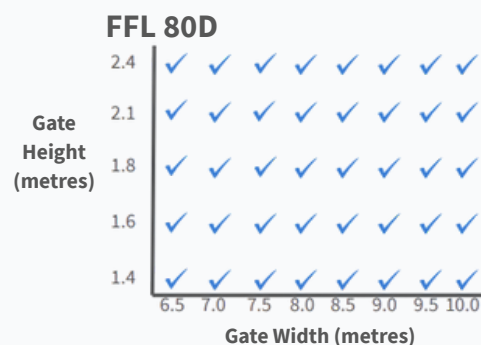
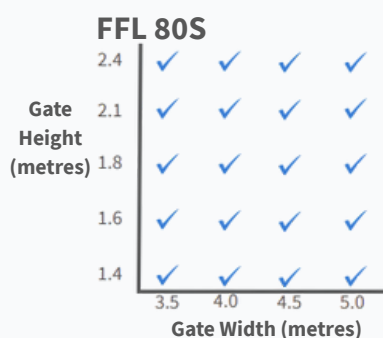
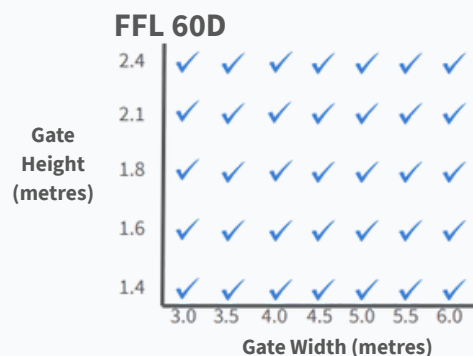
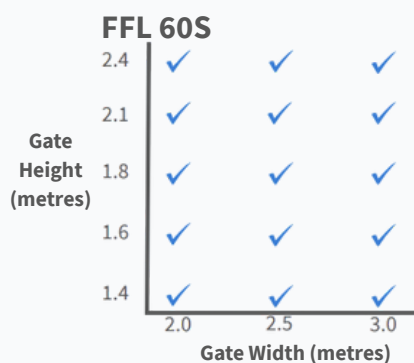

### Standard Colours

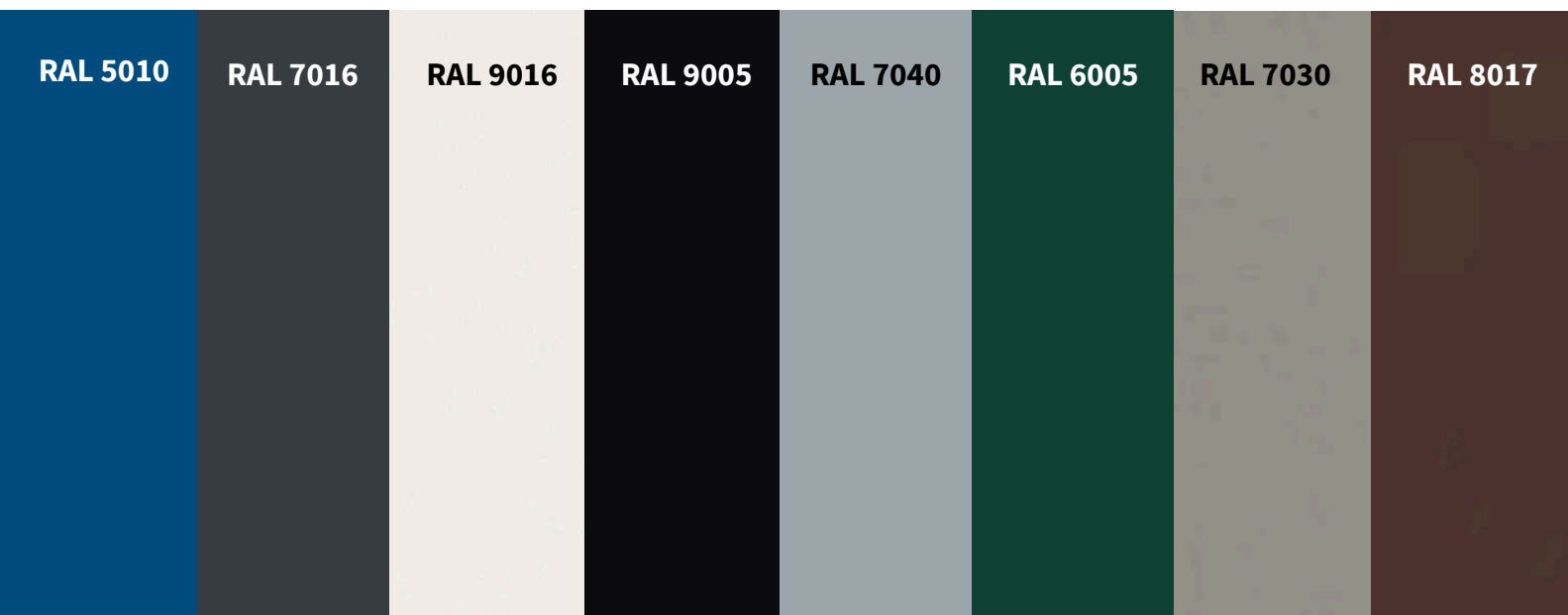

Above is the standard colour range, however, there are over 200 RAL colours available on request.



01283 512 111



[www.firstfence.co.uk](http://www.firstfence.co.uk)



[sales@firstfence.co.uk](mailto:sales@firstfence.co.uk)



## Why Choose The FFL Range From First Fence?

### Available Choice

Wide range of sizes, colour and infill options mean plenty of choice to suit all entrances.

### Expert Manufacturing

Wisniowski, the manufacturer of this range, have over 40 years experience and is one of the biggest suppliers in Europe.

### Nationwide Delivery

Get the products you need, where you need them, with our reliable delivery fleet.



**For All Press Release Enquiries:**

Toby Roberts-Davies  
Product Innovation Manager  
[Toby.roberts-davies@firstfence.co.uk](mailto:Toby.roberts-davies@firstfence.co.uk)

First Fence Ltd  
Kiln Way,  
Woodville,  
Swadlincote,  
Derbyshire  
DE11 8EA



**01283 512 111**



**[www.firstfence.co.uk](http://www.firstfence.co.uk)**



**[sales@firstfence.co.uk](mailto:sales@firstfence.co.uk)**